

CERTIFIED RECORD OF LAND CORNER MONUMENTATION

History of original corner establishment:
New Corner

*

DIAGRAM
T10S R31E
N1/16
S111S12

Description of corner evidence found:

Description of monument and accessories I establish to perpetuate the original location of this corner:

Set a 2 1/2 x 28" aluminum monument 3" in the ground in a mound of stone.

T10S R31E
N1/16
S111S12
PLS1918
1988

I establish new bearing trees:

An 8" Juniper bears S 28 1/2° E, 143.7 ft, scribed N1/16S12BT.

An 8" Juniper bears S 17-3/4° W, 214.9 ft, scribed N1/16S11BT.

New BTs have 3/4" brass washers marked PLS1918 attached to the BT blaze, faces and bands painted with red tree marking paint, and BT tags and Attention or Land Survey Monument signs. A steel fence post with Attention or Land Survey Monument sign is driven approximately 3-5 feet from the corner.

Sun Cadastral Survey, Cont No. 53-04H1-7-4011

Field Book: 4-31.

Work accomplished: 8/19/88

Witnesses: Louise Parsons, Douglas Parsons

Job No.: 87221

PARSONS SURVEYING
1915 S.E. Stone Street
Corvallis, OR 97333
(503) 752-7515

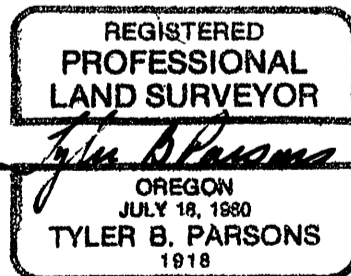

Office of COUNTY SURVEYOR County of GRANT
State of OREGON, I hereby certify that the within instrument was filed in this office
for record on the 14th day of Feb, 19 89

Robert D. Bayle by _____
(COUNTY OFFICIAL) (DEPUTY)